

The Public Market Annex II

All costs are for the
3-day event

Sections A and B
Spaces 1 & 2 = \$145 each

Sections C through F
1, 2 = \$170 per space
3, 4, 5, 6 = \$195 per space

Perimeter

P-1 =	\$200
P-2 =	\$200
P-3 =	\$165
P-4 =	\$165
P-5 =	\$165
P-6 =	\$200
P-7 =	\$250
P-8 =	\$250
P-9 =	\$250
P-10 =	\$250
P-11 =	\$210
P-12 =	\$325
P-13 =	\$325
P-14 =	\$200
P-15 =	\$200

**One table provide free for
each space**

Additional tables = \$10.00 ea.

Electricity = \$10

CBJ sales tax applies

For more, see:

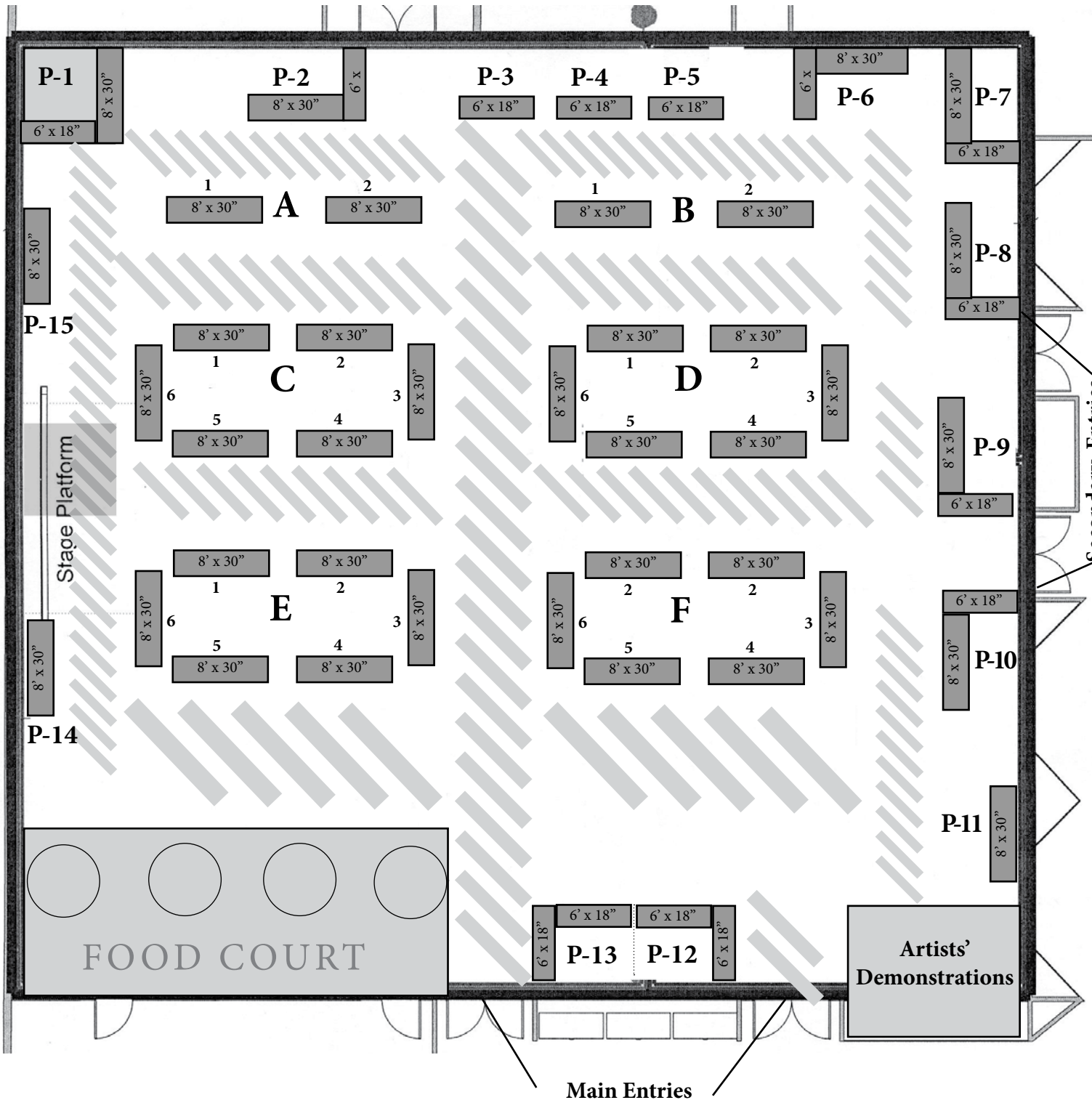

Main Entries

Secondary Entries