

THE THIRTY-SIXTH ANNUAL PUBLIC MARKET

CENTENNIAL HALL FLOOR PLANS

These diagrams are not to scale

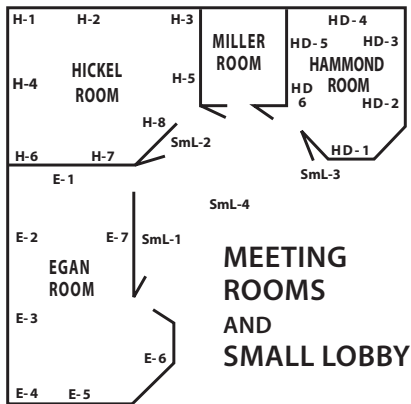
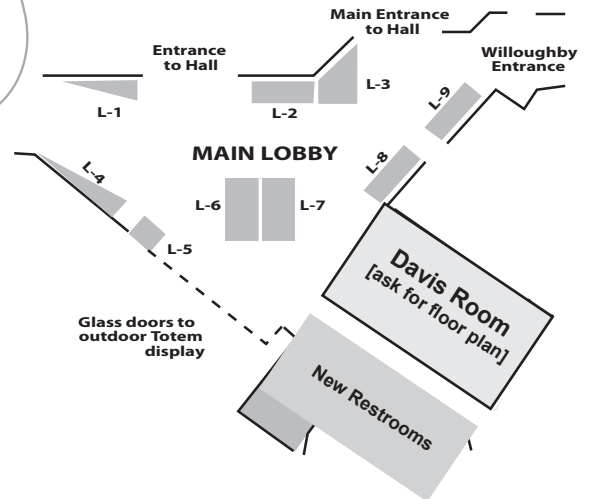
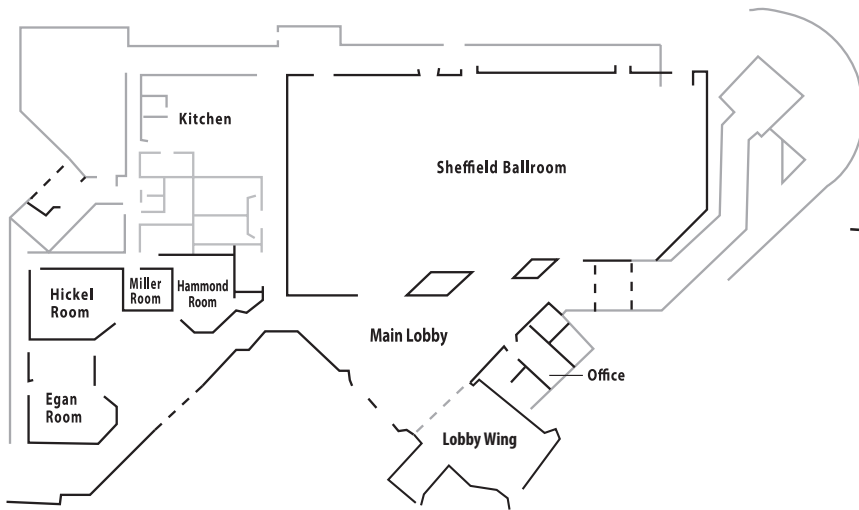

Sheffield Ballroom • Typical Booth Construction

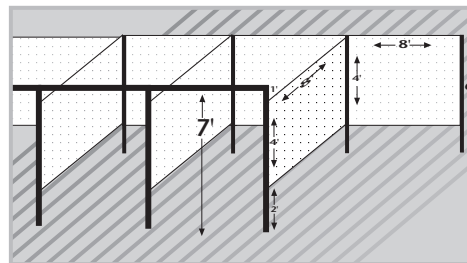

All space rentals in the Sheffield Ballroom are booths, constructed of panels (1/8" pegboard mounted on 2" x 2" frames), typically 8' x 8' by 6' tall. Solid lines represent panels that form the sidewalls of the booth. Dotted lines represent open sides. All space rentals in lobby areas and meeting rooms are open table displays.

LETTER CODE

- SHEFFIELD BALLROOM:**
- STANDING SECTIONS = A, B, C, D
- PERIMETER = P
- MAIN LOBBY = L**
- DAVIS ROOM = DV**
- SMALL LOBBY = SML**
- EGAN = E**
- HICKEL = H**
- HAMMOND = HD**
- PUBLIC MARKET ANNEX = ANX**

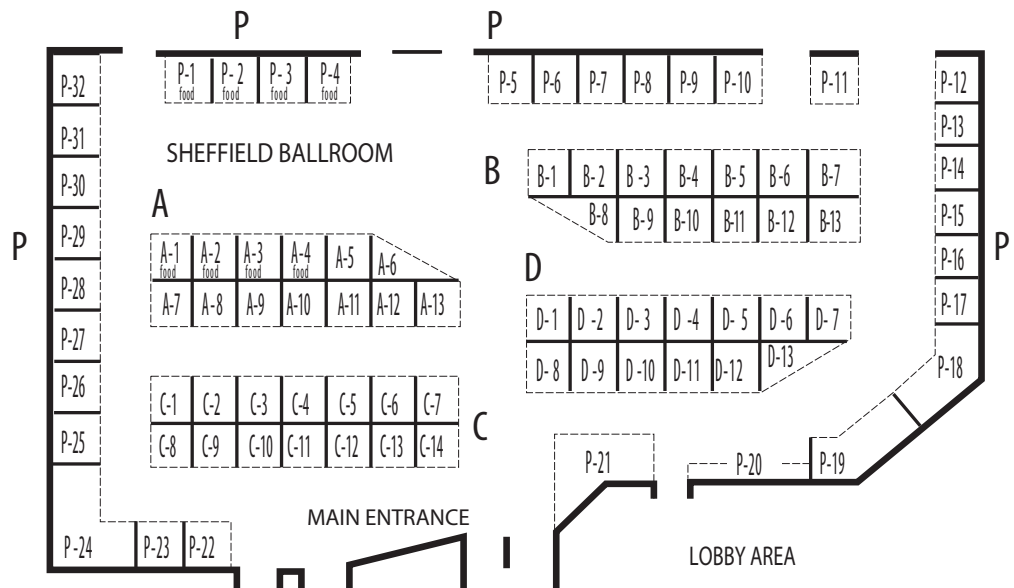

THE T H I R T Y - S I X T H A N N U A L PUBLIC MARKET ANNEX

PUBLIC MARKET ANNEX FLOOR PLAN

The Annex "ANX" is Located in the
Juneau Arts and Culture Center "JACC"

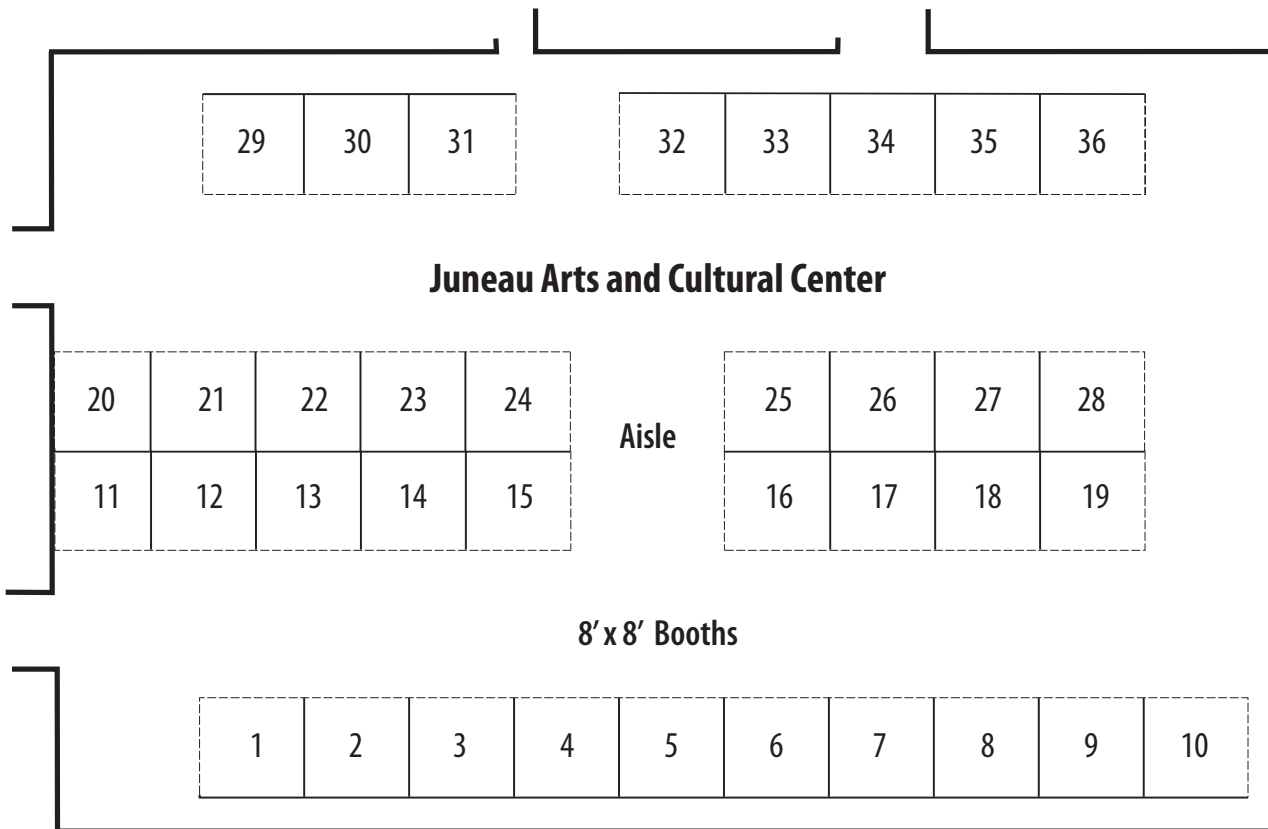

BOOTH LAYOUT FOR THE PUBLIC MARKET ANNEX

This photo was taken from the perspective of the corner next to space #29

Each Annex booth is defined by pipe frame & drape separators, with sidewalls that are approximately 3' high. Perimeter booths have an 8' high back, while the center section booths do not. Creative use of each space is encouraged, but please let us know your intentions prior to the event.